



DRIVECONTROL 54

The all-purpose interface for the RollerDrive EC310



Product Description

Properties The DriveControl 54 is the all-purpose interface for the RollerDrive EC310. The direction of rotation and 15 different speeds can be set using DIP switches. Optically decoupled digital I/O's act as the interface to a higher-order controller. This enables, for instance, the direction of rotation of the 7 different speeds to be set from a PLC. The braking energy of the RollerDrive is fed back into the 24 V grid. The voltage fed back from the RollerDrive EC310 is limited at 26 V by means of the integral brake chopper (voltage-dependently switched load resistance).

- Functions**
- Speed adjustment (15 speeds internally, 7 speeds externally via I/O)
 - Choice of rotational direction
 - Start signal input
 - Rotational direction signal input
 - Fault signal output
 - LED status display
 - Sealed cable openings

Technical Data

Electrical data	
Rated voltage	24 V DC
Temporarily permissible voltage range	18 to 26 V DC
Permissible voltage undulation	3 %, recommended: < 1 %
Rated current	2.0 A
Max. start-up current	5.0 A
Fuse	present, non-replaceable
Protection rate	IP54
Ambient conditions	
Ambient temperature in operation	-28 to +40 °C
Ambient temperature during transport and storage	-30 to +80 °C
Max. temperature change	1 % in 3 h; 2 cycles in compliance with IEC 60068-2-14
Max. air humidity	90 %, non-condensing
Cable cross-sections	
Power Supply	Fine-wired, 1.5 mm ² (AWG 16)
Inputs / Outputs (I/O)	Fine-wired, 0.08 to 0.5 mm ² (AWG 28 to 20)

The effective current in the application depends on the conveyor weight, conveyor speed and number of cycles.

Reference number: 89RB

Dimensions and Connections

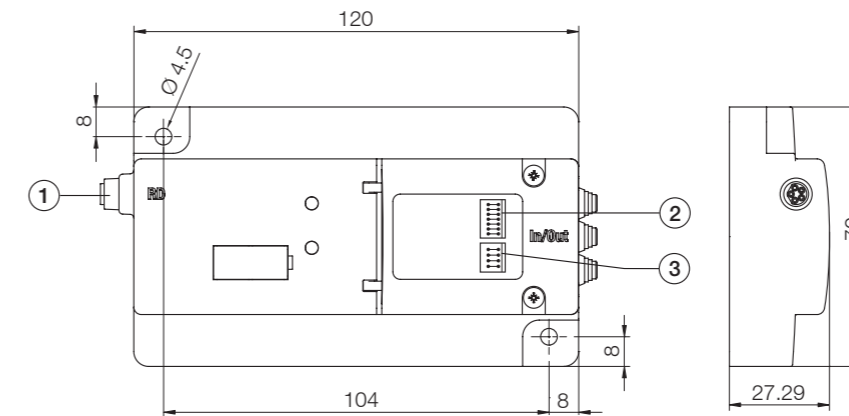

Pos. 1 RollerDrive Connection

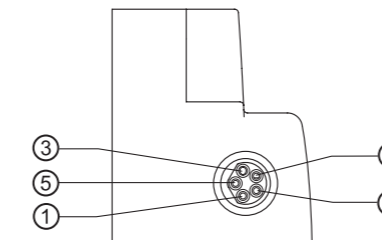

- | | |
|---|-----------------------|
| 1 | +24 V DC |
| 2 | Direction of rotation |
| 3 | Earth |
| 4 | Fault input |
| 5 | Analogue speed output |

Pos. 2 Inputs/Outputs

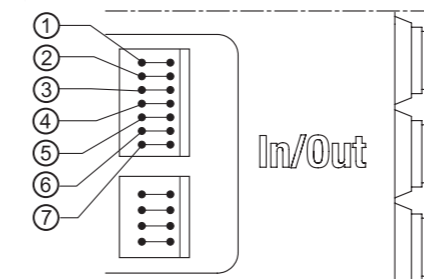

- | | |
|---|-----------------------|
| 1 | Common signal mass |
| 2 | 24 V input |
| 3 | Fault output |
| 4 | Direction of rotation |
| 5 | Speed C |
| 6 | Speed B |
| 7 | Speed A |

Pos. 3 Power Supply

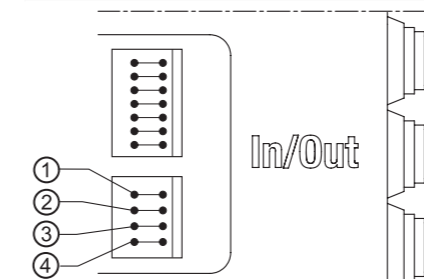

- | | |
|---|----------|
| 1 | Earth |
| 2 | +24 V DC |
| 3 | Earth |
| 4 | +24 V DC |