

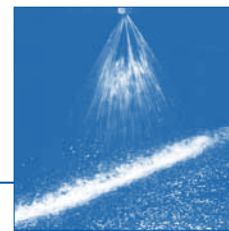

Flat fan nozzle tips with dovetail guide Series 660

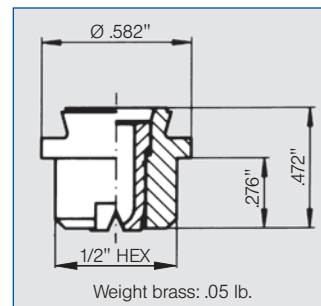

Automatic jet alignment due to dovetail guide (this tip requires dovetail base). Stable spray angle. Uniform parabolic distribution of liquid. With appropriate spray height and distance between centers on spray bar, provides an even total liquid distribution. Assembles with 3/8" retaining nut.



Orifice offset from dovetail by 5°

Applications:

- Cleaning installations
- Cooling headers
- Spray pipes

Spray angle	Ordering no.				Equivalent Orifice diam. (in.)	Free passage (in.)	Flow Rate (Gallons Per Minute)							Spray Coverage @ 30 psi	
	Type	Material no.					10 psi	20 psi	liters per minute 2 bar	40 psi	60 psi	80 psi	100 psi	H=10"	H=20"
		303 SS 16	316 SS 17	Brass 30											
20°	660.301	○	○	○	.028	.024	.05	.07	.32	.10	.12	.14	.16	2	4
	660.361	○	○	○	.039	.032	.10	.14	.63	.20	.24	.28	.31	3	5
	660.441	○	○	○	.053	.043	.19	.27	1.3	.39	.48	.55	.61	3	5
	660.481	○	○	○	.059	.047	.25	.35	1.6	.50	.61	.70	.78	3	5
30°	660.302	○	○	○	.024	.020	.05	.07	.32	.10	.12	.14	.16	4	8
	660.362	○	○	○	.039	.028	.10	.14	.63	.20	.24	.28	.31	4	8
	660.402	○	○	○	.047	.035	.16	.22	1.0	.31	.38	.44	.49	4	8
	660.482	○	○	○	.059	.043	.25	.35	1.6	.50	.61	.70	.78	4	8
	660.562	○	○	○	.079	.059	.39	.55	2.5	.78	.95	1.1	1.2	4	8
45°	660.303	○	○	○	.028	.020	.05	.07	.32	.10	.12	.14	.16	7	13
	660.363	○	○	○	.039	.024	.10	.14	.63	.20	.24	.28	.31	7	13
	660.403	○	○	○	.047	.035	.16	.22	1.0	.31	.38	.44	.49	7	13
	660.483	○	○	○	.059	.043	.25	.35	1.6	.50	.61	.70	.78	7	13
	660.563	○	○	○	.079	.055	.39	.55	2.5	.78	.95	1.1	1.2	7	14
60°	660.643	○	○	○	.099	.071	.62	.88	4.0	1.2	1.5	1.8	2.0	7	14
	660.304	○	○	○	.028	.016	.05	.07	.32	.10	.12	.14	.16	11	21
	660.334	○	○	○	.035	.020	.07	.10	.45	.14	.17	.20	.22	11	21
	660.364	○	○	○	.039	.024	.10	.14	.63	.20	.24	.28	.31	11	21
	660.404	○	○	○	.047	.032	.16	.22	1.0	.31	.38	.44	.49	11	21
	660.444	○	○	○	.053	.035	.19	.27	1.3	.39	.48	.55	.61	11	21
	660.484	○	○	○	.059	.039	.25	.35	1.6	.50	.61	.70	.78	11	21
	660.514	○	○	○	.065	.043	.29	.42	1.9	.59	.72	.83	.93	11	21
	660.564	○	○	○	.079	.051	.39	.55	2.5	.78	.95	1.1	1.2	11	21
	660.604	○	○	○	.087	.059	.49	.69	3.2	.98	1.2	1.4	1.5	11	21
75°	660.644	○	○	○	.099	.063	.62	.88	4.0	1.2	1.5	1.8	2.0	11	21
	660.724	○	○	○	.118	.083	.98	1.4	6.3	2.0	2.4	2.8	3.1	11	20
	660.804	-	○	○	.158	.102	1.6	2.2	10.0	3.1	3.8	4.4	4.9	11	20
	660.145	○	-	○	.008	.005	.008	.011	.05	.016	.019	.022	.025	13	24
	660.165	○	-	○	.008	.003	.011	.015	.07	.022	.027	.031	.034	13	24
	660.185	○	-	○	.008	.006	.012	.018	.09	.025	.030	.035	.039	13	25
	660.215	○	-	○	.020	.008	.017	.024	.11	.034	.042	.048	.054	13	25
	660.245	○	-	○	.020	.300	.025	.035	.16	.05	.06	.07	.08	14	25
660.275	○	-	○	.024	.300	.034	.05	.22	.07	.08	.10	.11	14	25	

Example Type + Material no. = Ordering no.
for ordering: 660.304 + 16 = 660.304.16

Continued on next page.

1) We reserve the right to deliver material 316 SS or 316L SS, if we show the material code 17.

A listing of alternatives for various assembly possibilities is shown in the Accessories section beginning on page 123.



