

Nozzle bodies and spray boom parts

Nozzle bodies for winged bayonet caps and hose barbs for dry booms



	Diameter		Part No.
	In.	mm	
 Single hose barb	3/8	10	Y8231001
	1/2	13	Y8231003
	3/4	19	Y8231005
 Tee hose barb	3/8	10	Y8231007
	1/2	13	Y8231009
	3/4	19	Y8231011
 Cross hose barb	3/8	10	Y8231013
	1/2	13	Y8231015
	3/4	19	Y8231017
 Single hose barb w/side diaphragm	3/8	10	Y8235001
	1/2	13	Y8235003
	3/4	19	Y8235005
 Tee hose barb w/side diaphragm	3/8	10	Y8235007
	1/2	13	Y8235009
	3/4	19	Y8235011
 Cross hose barb w/side diaphragm	3/8	10	Y8235013
	1/2	13	Y8235015
	3/4	19	Y8235017

- Nylon construction
- Diaphragm check valves set for 7 psi, with 3, 4.5 and 15 PSI available upon request. For diaphragm parts, see page 54.
- EPDM Gaskets, Viton® upon request





Nozzle bodies and spray boom parts

Nozzle bodies for winged bayonet caps and hose barbs for dry booms

	Diameter		Part No.
	In.	mm	
 Single hose barb w/top diaphragm	3/8	10	Y8235019
	1/2	13	Y8235021
	3/4	19	Y8235023
 Tee hose barb w/top diaphragm	3/8	10	Y8235025
	1/2	13	Y8235027
	3/4	19	Y8235029





	Diameter			Part No.
	Pipe OD	Hose ID	Port	
 Single hose barb for Multijet Rotary style nozzle bodies	1/2"	1/2"	.41"	Y8294014
	3/4"	3/4"	.41"	Y8294015
	3/4"	1"	.41"	Y8294016
	1/2"	1/2"	.41"	Y8294023
	1"	3/4"	.41"	Y8294028
	1"	1"	.41"	Y8294029
 Double hose barb for Multijet Rotary style nozzle bodies	1/2"	1/2"	.41"	Y8294017
	3/4"	3/4"	.41"	Y8294018
	3/4"	1"	.41"	Y8294019
	1/2"	1/2"	.41"	Y8294024
	1"	3/4"	.41"	Y8294030
	1"	1"	.41"	Y8294031

Nozzle bodies and spray boom parts

Nozzle bodies for winged bayonet caps and hose barbs for dry booms





	Diameter		Part No.
	In.	mm	
 Single hose barb w/ 1/4" F NPT	3/8	10	Y8231018
	1/2	13	Y8231020
	3/4	19	Y8231022
 Tee hose barb w/ 1/4" F NPT	3/8	10	Y8231024
	1/2	13	Y8231026
	3/4	19	Y8231028
 Cross hose barb w/ 1/4" F NPT	3/8	10	Y8231030
	1/2	13	Y8231032
	3/4	19	Y8231034

- Nylon construction
- EPDM Gaskets,
- Viton® upon request
- Diaphragm check valves set for 7 psi, with 3, 4.5 and 15 PSI available upon request. For diaphragm parts, see page 54.

	Diameter		Part No.
	In.	mm	
 Single hose barb triple nozzle holder w/ diaphragm check for winged bayonet caps	1/2	13	Y8240001
	3/4	19	Y8240003
 Tee hose barb triple nozzle holder w/ diaphragm check for winged bayonet caps	1/2	13	Y8240005
	3/4	19	Y8240007

Nozzle bodies and spray boom parts

Nozzle bodies for winged bayonet caps and hose barbs for dry booms

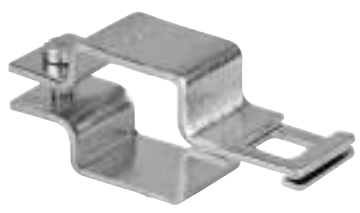
	Diameter		Part No.
	In.	mm	
 Cross hose barb w/ 1/4" F NPT	1/2	13	Y8240009
	3/4	19	Y8240011
 Single right hose barb triple nozzle holder w/ diaphragm check for winged bayonet caps	1/2	13	Y8235035
 Double hose barb triple nozzle holder w/diaphragm check for winged bayonet caps	1/2	13	Y8235033
 Single left hose barb triple nozzle holder w/ diaphragm check for winged bayonet caps	1/2	13	Y8235031
 Mounting clamps for nozzle holders, round pipe	3/4	19	Y8235036*
	1	25	Y8235038*
	1 1/4	32	Y8235040*
 Mounting clamps for nozzle holders, square tube	3/4	19	Y8235037*
	1	25	Y8235039*
	1 1/4	32	Y8235041*
	1 1/2	38	Y8235043*

*For stainless steel, add "SS" to Part No.

Nozzle bodies and spray boom parts

Multijet rotary style nozzle bodies for wet or dry booms



- Nylon construction, other materials available upon request
- Includes O-ring gasket, screw and nut clamp
- 304 Stainless Steel internal parts
- EPDM or Viton® gaskets
- Other sizes available upon request

	Dimensions (inches)			EPDM		Viton®	
				Part No. by Check Valve Position		Part No. by Check Valve Position	
	F	D	B	Right	Left	Right	Left
Triple nozzle bodies	0.28	1/2"	0.93	Y8244054	Y8244055	Y8244066	Y8244067
	0.39	1/2"	0.93	Y8244078	Y8244079	Y8244090	Y8244091
	0.39	3/4"	0.93	Y8244102	Y8244103	Y8244114	Y8244115
	0.39	1"	1.16	Y8244138	Y8244139	Y8244156	Y8244157
Quadruple nozzle bodies	0.28	1/2"	0.93	Y8244056	Y8244057	Y8244068	Y8244069
	0.39	1/2"	0.93	Y8244080	Y8244081	Y8244092	Y8244093
	0.39	3/4"	0.93	Y8244104	Y8244105	Y8244116	Y8244117
	0.39	1"	1.16	Y8244140	Y8244141	Y8244158	Y8244159
Quintuple nozzle bodies	0.28	1/2"	0.93	Y8244058	Y8244059	Y8244070	Y8244071
	0.39	1/2"	0.93	Y8244082	Y8244083	Y8244094	Y8244095
	0.39	3/4"	0.93	Y8244106	Y8244107	Y8244118	Y8244119
	0.39	1"	1.16	Y8244142	Y8244143	Y8244160	Y8244161



Replacement parts for wet and dry boom nozzle bodies

O-rings

Description	Part No.
EPDM spare diaphragm	YM00100000
Viton® spare diaphragm	YM00100001
Nozzle Body Dimension	Part No.
F	
0.28"	YG00001006
0.39"	YG00001008

To order hose barbs, see page 51.

For replacement single and double hose barbs, see pages 50-51.

Nozzle bodies and spray boom parts

Triple nozzle bodies with diaphragm check valves for wet boom

	Dimensions (inches)				EPDM	Viton®
	F1	F	D	H	Part No.	Part No.
	QUICK	0.28	1/2"	3.23	Y8239001	Y8239011
	QUICK	0.39	1/2"	3.23	Y8239003	Y8239013
	QUICK	0.28	3/4"	3.43	Y8239005	Y8239015
	QUICK	0.39	1"	3.43	Y8239021	Y8239023

- Nylon construction, other materials available upon request
- Includes O-ring gasket
- 304 Stainless Steel internal parts
- EPDM or Viton® gaskets
- Order with screw K000010000

	Dimensions (inches)				EPDM	Viton®
	QUICK	1/4" M NPT	—	—	Y8239007	Y8239017

For NPT/wet boom connection

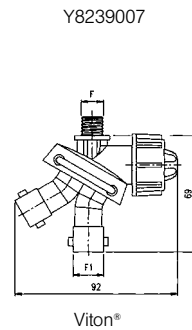
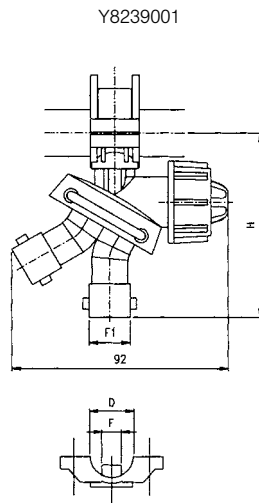

All dimensions in mm (except as noted)

Nozzle bodies and spray boom parts

Single nozzle bodies with diaphragm check valves for wet boom

	Dimensions			EPDM	Viton®	O-ring
	F1	F	D	Part No.	Part No.	
	QUICK	0.28"	20mm	Y8234001	Y8234017	YG00001006
		0.39"	20mm	Y8234003	Y8234019	YG00001008
		0.28"	1/2"	Y8234005	Y8234021	YG00001006
		0.39"	1/2"	Y8234007	Y8234023	YG00001008
		0.39"	25mm	Y8234026	Y8234027	YG00001008
		0.39"	3/4"	Y8234009	Y8234025	YG00001008
		0.39"	1"	Y8234051	—	YG00001008

- Nylon construction, other materials available upon request
- Includes O-ring gasket
- For clamp and O-ring gaskets pipe connection
- 304 Stainless Steel internal parts
- EPDM or Viton® gaskets
- Order with screw VK00007005

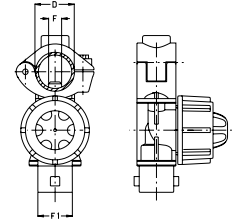

	Dimensions			EPDM	Viton®	O-ring
	F1	F	D	Part No.	Part No.	
	QUICK	1/4" M NPT	—	Y8234013	Y8234029	—
		1/4" M NPT	—	Y8234011	Y8234043	—
		3/8" F NPT	—	Y8234015	Y8234031	—
		11/16" F NPT	—	Y8234035	Y8234041	—
		1/4" F NPT	—	Y8234037	Y8234045	—
		1/4" F NPT	—	Y8234033	Y8234039	—
	1/4" NPT F	1/4" M NPT	—	Y8234040	Y8234044	—

For NPT/wet boom connection

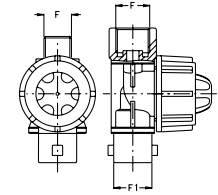

Single nozzle bodies with O-ring seal for small diameter boom pipes



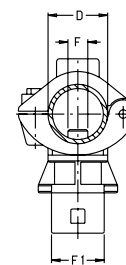

	Dimensions			Part No.
	F	F1	D	
	0.28"	QUICK	20mm	Y8230001
	0.39"	QUICK	20mm	Y8230003
	0.28"	QUICK	1/2"	Y8230005
	0.39"	QUICK	1/2"	Y8230007
	0.39"	QUICK	3/4"	Y8230009
	0.39"	QUICK	1"	Y8230011
	0.28"	QUICK	20mm	Y8230013



- Nylon construction, other materials available upon request
- 304 Stainless Steel internal parts
- EPDM gaskets

Nozzle bodies and spray boom parts

Galvanized and brass nozzle bodies for orchard and high pressure sprayers

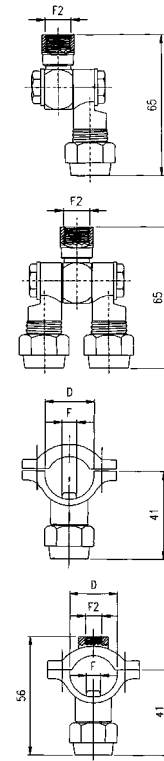

	Item	Dimensions				Part No.
		F	F2	D	L	
	Swivel, female, 3/8" fly nut	—	1/4" BSP	—	—	Y8247004
		—	1/4" NPT	—	—	Y8247005
		—	1/2" x 3/4" dia.	—	—	Y8247006
	Double swivel, female, 3/8" fly nuts	—	1/4" BSP	—	—	Y8247008
		—	1/4" NPT	—	—	Y8247009
		—	1/2" x 3/4" dia.	—	—	Y8247010
	Fixed with O-ring & 3/8" fly nut for 1/2" rods	1/4"	—	1/2"	—	Y8272004
	Fixed with O-ring & 3/8" fly nut for 1/2" rods with mounting hole	1/4"	8mm F	1/2"	—	Y8272005



- Swivel nozzle complete with BSP 3/8" fly nut
- NBR internal gaskets in swivels
- 304 Stainless Steel internal parts

All dimensions in mm (except as noted)

Spray booms

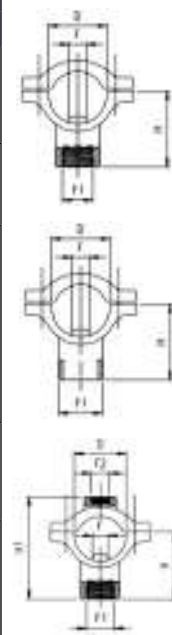

	Dimensions (mm except as noted)						Part No.
	D	F	F1	F2	H	H1	
 Nickel-plated brass clamp with O-ring gasket for 1/2" rods	1/2"	7	1/4" BSP	—	30	—	Y8272000
	1/2"	7	1/4" BSP	—	37.5	—	Y8272001
 Nickel-plated brass clamp with O-ring gasket for 1/2" rods	1/2"	7	—	1/4" M	30	—	Y8272006
 Nickel-plated brass clamp with O-ring gasket with 1/2" mounting hole	1/2"	7	1/4" BSP	MB	30	45.3	Y8272002
	1/2"	7	1/4" BSP	MB	37.5	52.8	Y8272003



- Nickel-plated Brass with Stainless Steel screws
- EPDM gaskets
- BSP threads
- For nozzle bodies on pages 59-60

Nozzle bodies and spray boom parts

Nylon swivel nozzle bodies for banding units



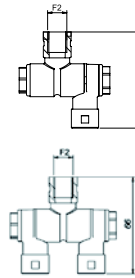

	F2	Part No.
	1/4" F BSP	Y8247011
1/4" F NPT	Y8247012	
3/8" F BSP	Y8247013	
	1/4" F BSP	Y8247014
	1/4" F NPT	Y8247015
	3/8" F BSP	Y8247016



- 304 Stainless Steel internal parts
- EPDM gaskets

All dimensions in mm (except as noted)

Disc cores for galvanized brass nozzle bodies for high pressure sprayers

	Description	Hole Diameter	Part No.
	Stainless steel disc core, 0.59" diameter	.04"	Y8259143
		.05"	Y8259144
		.06"	Y8259145
		.07"	Y8259146
		.08"	Y8259147
	Stainless steel core, 0.59" diameter	—	Y8259148
	Ceramic disk, 0.59" diameter	.03"	Y8259167
		.04"	Y8259168
		.05"	Y8259169
		.06"	Y8259170
		.07"	Y8259171
	Gasket for stainless steel core, 0.59" diameter	—	G00002032

Kits and parts for nozzle bodies for orchard sprayers

18mm core kits

Nozzle diameter (mm)	Core diameter (mm)	Part No.
0.8	Blank	Y8259211
1.0	Blank	Y8259212
1.2	Blank	Y8259213
1.2	1.2	Y8259214
1.5	Blank	Y8259215
1.5	1.2	Y8259216
1.5	1.5	Y8259217
1.8	Blank	Y8259218
1.8	1.5	Y8259219
1.8	1.8	Y8259220
2.0	Blank	Y8259221
2.0	1.8	Y8259222



Spare parts

	Hole (mm)	Part No.
1	—	YG00002046
	0.8	Y8259059
	1.0	Y8259060
2	1.2	Y8259061
	1.5	Y8259062
	1.8	Y8259063
	2.0	Y8259064
	3	—
4	Blank	Y8259067
	1.2	Y8259069
	1.5	Y8259070
	1.8	Y8259071
5	—	Y8259073



- Ceramic disc
- One each EPDM and PVC gasket
- Stainless Steel filter and core
- Fits nozzle bodies on pages 59-60

Plugs and nipples

	Part	Dimensions (mm)		Part No.
		F	F1	
	① Brass Plug	3/4" BSP	—	Y8304000
	① Brass Nipple	3/4" BSP	1/2"	Y8304001
	① Brass Nipple	3/4" BSP	3/4"	Y8304002
	② O-ring	—	—	YG00001058

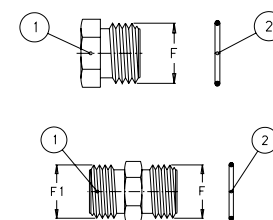

Nozzle bodies and spray boom parts

Triple nozzle bodies for high-pressure orchard sprayers – 720 psi maximum pressure

- Brass
- Adjustable
- Viton® diaphragm
- BSP threads (inlet and fly nut)

With diaphragm check valve and fly nuts

	Accepts Ceramic Discs	For Spray Nozzles	F	Part No.
Single	Ø 18mm	Kit Ø 18mm	1/4" M BSP	Y8267000
			1/4" F BSP	Y8267001
			3/8" M BSP	Y8267002
	TR, ID	TR, ID	1/4" M BSP	Y8267003
			1/4" F BSP	Y8267004
			3/8" M BSP	Y8267005
Double	2x Ø 18mm	Kit Ø 18mm	1/4" M BSP	Y8268000
			1/4" F BSP	Y8268001
			3/8" M BSP	Y8268002
	1x Ø 18mm - 1x Ø 15mm	Kit Ø 18mm - TR, ID	1/4" M BSP	Y8268003
			1/4" F BSP	Y8268004
			3/8" M BSP	Y8268005
	2x Ø 15mm	TR, ID	1/4" M BSP	Y8268006
			1/4" F BSP	Y8268007
			3/8" M BSP	Y8268008
Double with adjustable end	1x Ø 18mm - 1x Ø 15mm	Kit Ø 18 - Kit Ø 15	1/4" M BSP	Y8268009
			1/4" F BSP	Y8268010
			3/8" M BSP	Y8268011
	1x Ø 15mm - 1x Ø 15mm or 18mm	TR, ID - Kit Ø 15mm or 18mm	1/4" M BSP	Y8268012
			1/4" F BSP	Y8268013
			3/8" M BSP	Y8268014
Triple	3x Ø 18mm	Kit Ø 18mm	1/4" M BSP	Y8269000
			1/4" F BSP	Y8269001
			3/8" M BSP	Y8269002
			3/8" M - 1/8" F BSP	Y8269003
	3x Ø 15mm	TR, ID	1/4" M BSP	Y8269004
			1/4" F BSP	Y8269005
			3/8" M BSP	Y8269006
		3/8" M - 1/8" F BSP	Y8269007	
Quick fitting double	–	Kit Ø 18mm - Quick	1/4" M BSP	Y8268016
	–	Kit Ø 18mm - Quick	1/4" F BSP	Y8268017
	–	Kit Ø 18mm - Quick	3/8" M BSP	Y8268018
	–	Kit Ø 18mm - Quick	1/4" M BSP	Y8268019
	–	Kit Ø 18mm - Quick	1/4" F BSP	Y8268020
	–	Kit Ø 18mm - Quick	3/8" M BSP	Y8268021

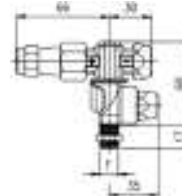
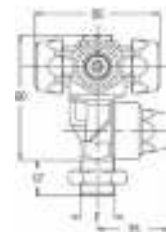
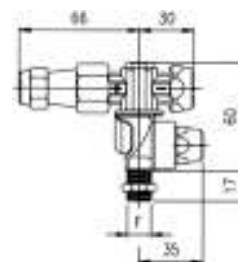
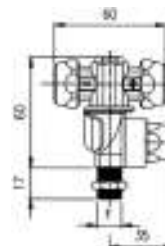
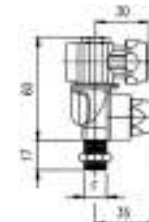



All dimensions in mm (except as noted)

Nozzle bodies and spray boom parts

Nozzle bodies for orchard sprayers

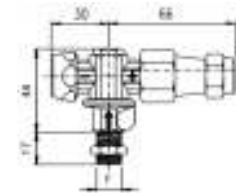
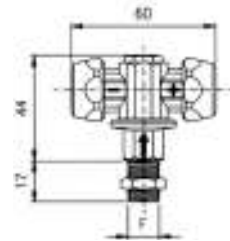
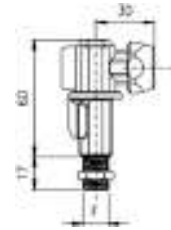

With fly nuts

	Accepts Ceramic Discs	For Spray Nozzles	F	Part No.
	Ø 18 mm	Kit Ø 18mm	1/4" M BSP	Y8264000
			1/4" F BSP	Y8264001
			3/8" M BSP	Y8264002
	TR, ID	TR, ID	1/4" M BSP	Y8264003
			1/4" F BSP	Y8264004
			3/8" M BSP	Y8264005
	2x Ø 18 mm	Kit Ø 18mm	1/4" M BSP	Y8265000
			1/4" F BSP	Y8265001
			3/8" M BSP	Y8265002
	1x Ø 18mm 1x Ø 15mm	Kit Ø 18mm - TR, IK	1/4" M BSP	Y8265003
			1/4" F BSP	Y8265004
			3/8" M BSP	Y8265005
	2x Ø 15 mm	TR, ID	1/4" M BSP	Y8265006
			1/4" F BSP	Y8265007
			3/8" M BSP	Y8265008
	1x Ø 18mm 1x Ø 15mm or 18mm	Kit Ø 18mm - Kit Ø 15mm or 18 mm	1/4" M BSP	Y8265009
			1/4" F BSP	Y8265010
			3/8" M BSP	Y8265011
	1x Ø 15mm - 1x Ø 15mm or 18mm	TR, ID - Kit	1/4" M BSP	Y8265012
			1/4" F BSP	Y8265013
			3/8" M BSP	Y8265014



All dimensions in mm (except as noted)

Spare brass fly nuts

	Accepts Ceramic Discs	Part No.
	Ø 18mm	Y8270000
	Ø 15mm	Y8270001
	Ø 15mm or 18mm	Y8304026

- Brass
- Adjustable
- Viton® diaphragm
- BSP threads (inlet and fly nut)