

Item description/product images

**Description****Material, version:**

Plate stainless steel 1.4301, polished.

Threaded spindle stainless steel 1.4301, bright.

Rubber base and rubber seal (EPDM), grey.

Note:

The levelling foot has an adjustment sleeve which covers the part of the thread. An O-ring is inserted inside the sleeve to prevent dirt from entering. This levelling foot is also equipped with a grey EPDM seal at the junction between the foot and the threaded spindle. This ensures stringent legal hygiene standards are met. The round shape and the sealed junction at the foot/thread allow this foot to be easily cleaned.

EPDM complies with the guidelines specified in the USDA documentation for rubber products.

The stainless steel levelling feet for sterile areas received the Equipment Acceptance Certificate of the USDA (US-Department of Agriculture).

The load values specified in the table are based on a test series in which a static load was applied perpendicular to the plates through the centre of the spindle. Radially acting forces, such as those produced by vibrations or other shaking effects, affect the load rating and are not taken into account for the specified values.

Drawings

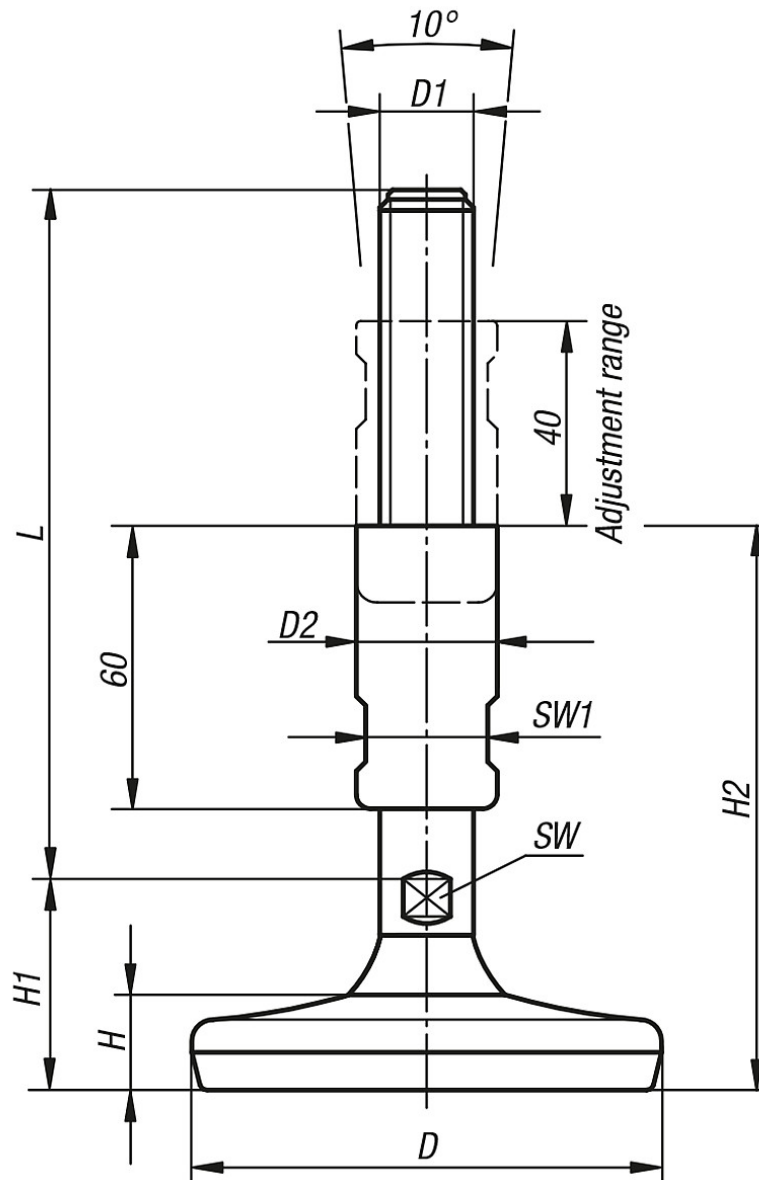

Overview of items

Order No.	D	D1	D2	H	H1	H2	SW	SW1	L	Load rating max. kN	Approx. weight kg
50-44-1	80	M16	25	30	48	126	13	20	143	10	0,552
50-44-2	80	M20	30	30	48	126	17	26	143	10	0,735
50-44-3	100	M16	25	35	53	132	13	20	144	15	0,706
50-44-4	100	M20	30	35	53	132	17	26	144	15	0,899
50-44-5	100	M24	35	35	53	132	20	30	144	15	1,005
50-44-6	120	M16	25	37	55	134	13	20	144	30	1,065
50-44-7	120	M20	30	37	55	134	17	26	144	30	1,248
50-44-8	120	M24	32	37	55	134	20	30	144	30	1,354

Overview of items
