

NEW

Ampco ZP1 Lip Seal Design ***For the Oil and Gas Industry***

Ampco's Standard ZP1 pump has been modified with a PTFE double lip seal to match the ZP1's robust design with outstanding chemical and wear resistance.

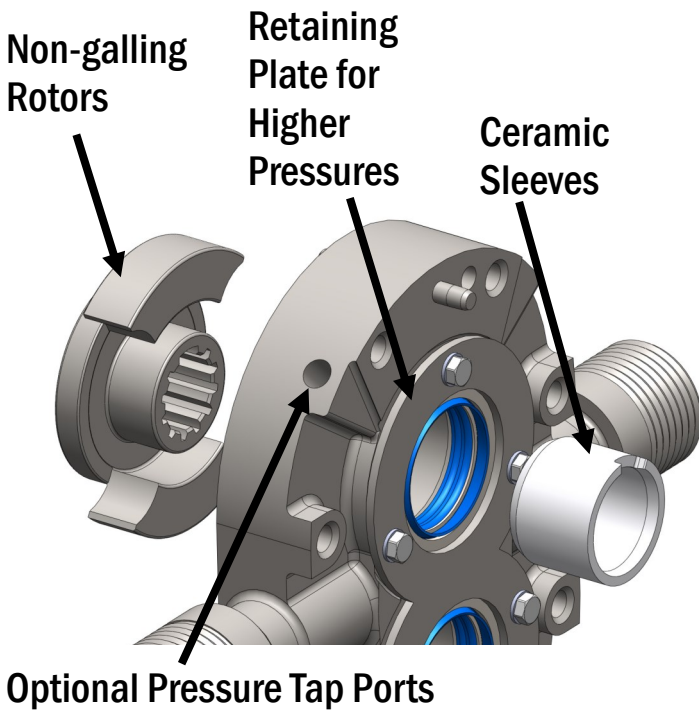
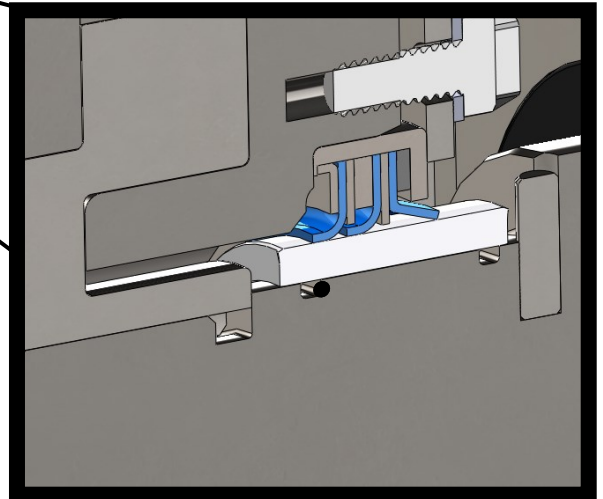
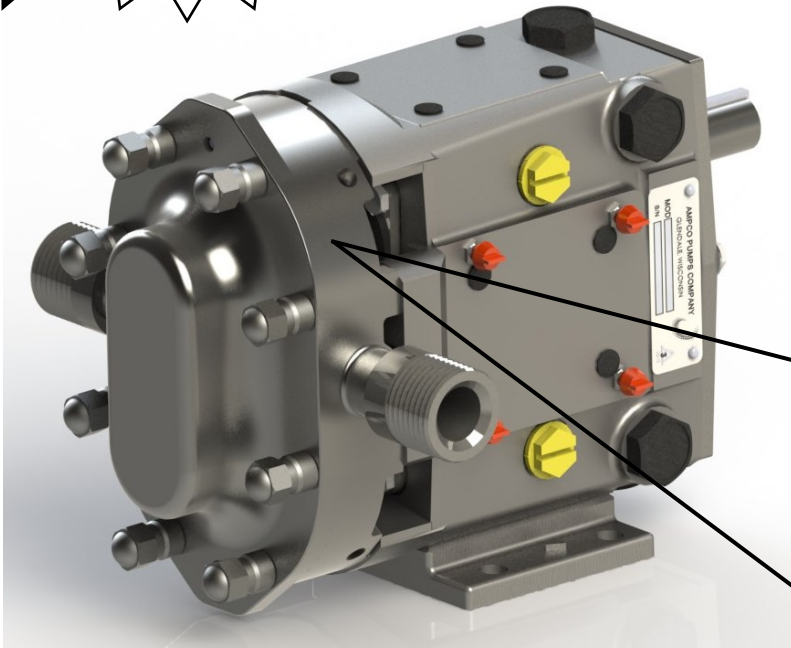

Features:

- Chemically Resistant PTFE Seal
- Stainless Steel Gear Case
- One Piece Stainless Steel Shafts
- Stainless Steel Bearing Retainers
- Sealed Cleanout Plugs
- Assortment of Connection Options
- Time Tested Pump Design

Ampco Pumps Company

2045 West Mill Road, Glendale, WI 53209 USA
Phone: (800) 737-8671 or (414) 643-1852
Website: www.ampcopumps.com

