

Item description/product images



Description

Material:

Lever stainless steel 1.4308.
Pressure pad black PA 66 GF 35-X.
Hinge pin, washer and stud stainless 1.4305.

Version:

Lever electrolytic polished.
Fibreglass reinforced plastic pressure pad, black.
Hinge pin, washer and stud, bright.

Note:

Adjustable cam levers are used where the position of the lever relative to the clamping axis only permits one specific position (e.g. confined spaces). The exact position of the lever can be set and adjusted over the grub screw on top of the cam using a screwdriver.

Drawings

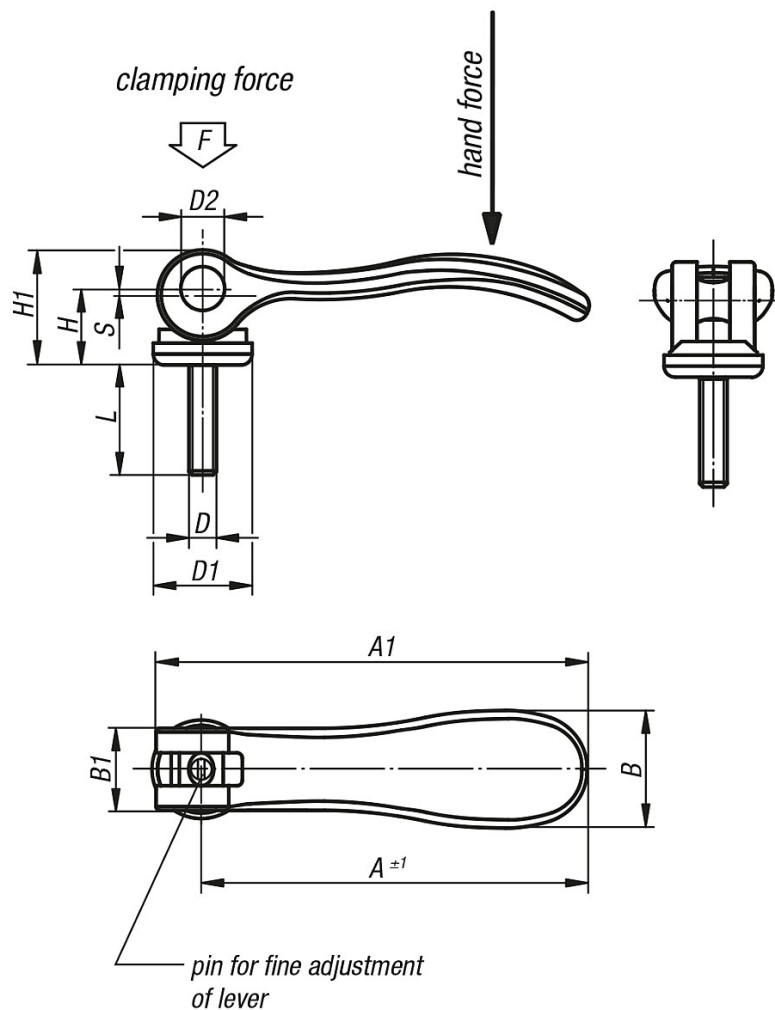

Overview of items

Order No.	Size	External thread D	D1	D2	B	B1	H	H1	A	A1	Clamping force F (kN)	Hand force N	Stroke S	L
30-67-1	1	M5	18	9	21,5	15	14,5	22	70,4	79,2	4	120	1,2	20
30-67-2	1	M5	18	9	21,5	15	14,5	22	70,4	79,2	4	120	1,2	40
30-67-3	1	M6	18	9	21,5	15	14,5	22	70,4	79,2	4	120	1,2	20
30-67-4	1	M6	18	9	21,5	15	14,5	22	70,4	79,2	4	120	1,2	40
30-67-5	2	M8	27	11	33,2	24	18	28,5	96	108	8	350	1,5	25
30-67-6	2	M8	27	11	33,2	24	18	28,5	96	108	8	350	1,5	50
30-67-7	2	M10	27	11	33,2	24	18	28,5	96	108	8	350	1,5	25
30-67-8	2	M10	27	11	33,2	24	18	28,5	96	108	8	350	1,5	50