

## Item description/product images



## Description

**Material:**

Stainless steel 1.4305.

**Version:**

Bright.

**Note:**

The full ball Form A is used where a single contact point is required.

The flattened ball Form B is used where an unparallel surface must be clamped or supported torsion free. The flat end can pivot through 9°.

## Drawings

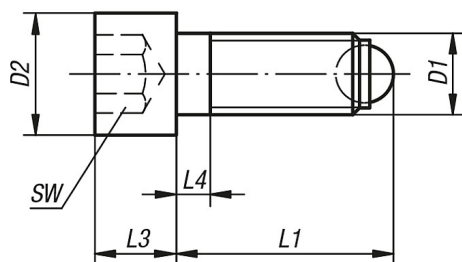
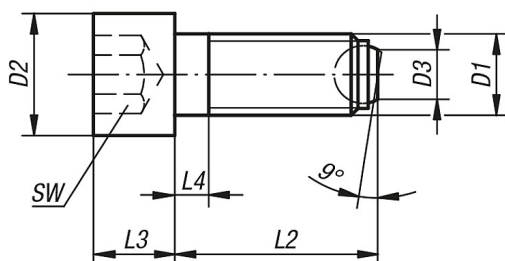
Form A  
with full ballForm B  
with flattened ball

## Overview of items

Order No.	Form	D1	D2	L1	L3	L4	Ball-Ø	SW
30-35-1	A	M6	10	20,8	6	3	4	5
30-35-2	A	M6	10	30,8	6	3	4	5
30-35-3	A	M6	10	40,8	6	16	4	5
30-35-4	A	M8	13	21,2	8	3,5	5,5	6
30-35-5	A	M8	13	36,2	8	3,5	5,5	6
30-35-6	A	M8	13	51,2	8	22	5,5	6
30-35-7	A	M10	16	26,7	10	4,5	7	8
30-35-8	A	M10	16	41,7	10	4,5	7	8
30-35-9	A	M10	16	61,7	10	28	7	8
30-35-10	A	M12	18	32	12	5	8,5	10
30-35-11	A	M12	18	52	12	5	8,5	10

## Overview of items

Order No.	Form	D1	D2	L1	L3	L4	Ball-Ø	SW
30-35-12	A	M12	18	82	12	44	8,5	10
30-35-13	A	M16	24	43,3	16	6	12	14
30-35-14	A	M16	24	63,3	16	6	12	14
30-35-15	A	M16	24	83,3	16	36	12	14

Order No.	Form	D1	L2	D2	D3	L3	L4	Ball-Ø	SW	Load rating max. kN (static load only)
30-36-1	B	M6	20	10	3,2	6	3	4	5	9
30-36-2	B	M6	30	10	3,2	6	3	4	5	9
30-36-3	B	M6	40	10	3,2	6	16	4	5	9
30-36-4	B	M8	20	13	4,5	8	3,5	5,5	6	15
30-36-5	B	M8	35	13	4,5	8	3,5	5,5	6	15
30-36-6	B	M8	50	13	4,5	8	22	5,5	6	15
30-36-7	B	M10	25	16	6	10	4,5	7	8	20
30-36-8	B	M10	40	16	6	10	4,5	7	8	20
30-36-9	B	M10	60	16	6	10	28	7	8	20
30-36-10	B	M12	30	18	7,2	12	5	8,5	10	30
30-36-11	B	M12	50	18	7,2	12	5	8,5	10	30
30-36-12	B	M12	80	18	7,2	12	44	8,5	10	30
30-36-13	B	M16	40	24	10,7	16	6	12	14	60
30-36-14	B	M16	60	24	10,7	16	6	12	14	60
30-36-15	B	M16	80	24	10,7	16	36	12	14	60