

Item description/product images

**Description****Material:**

Stainless steel 1.4125

Version:

Bright.

Note:

The guide rails can be screwed down from above.

The rails are available in three sizes on which one or more carriages can be mounted.

If the rails are to be laid in series, the ends need to be milled or ground. Please indicate when ordering.

Drawings

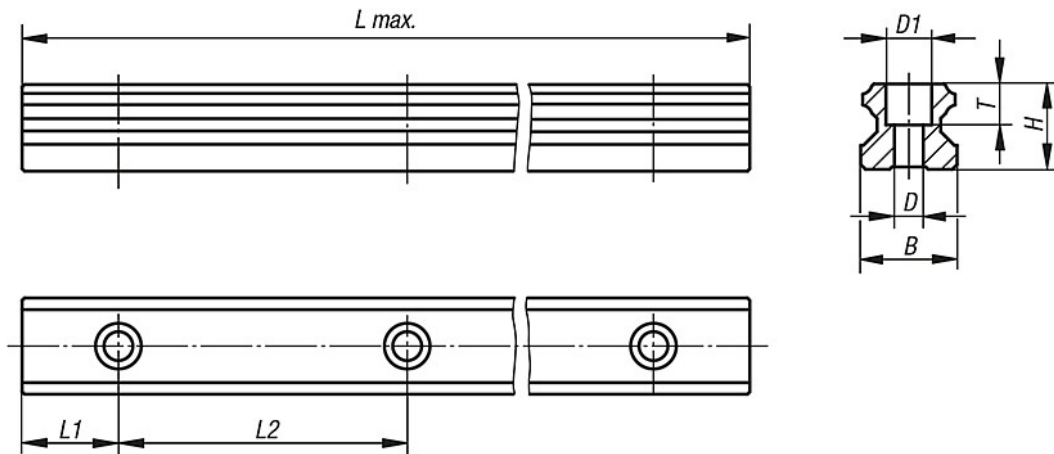

Application possibilities:
 profile guide rails with carriages arranged as guide systems

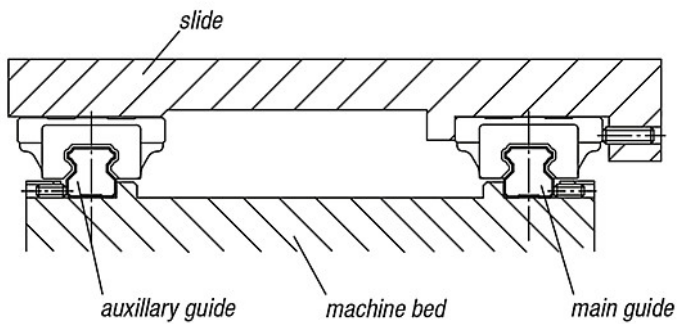
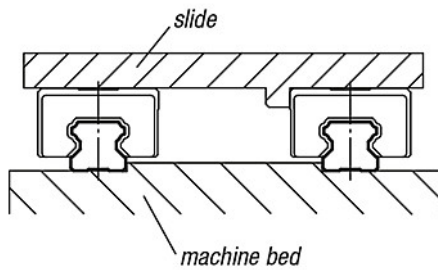

Overview of items

Order No.	Size	B	D	D1	H	L max.	L1	L2	T
50-207-1	15	15	4,5	7,5	15	1.780	20	60	5,3
50-207-2	20	20	6	9,5	18	3.460	20	60	8,5
50-207-3	25	23	7	11	22	3.460	20	60	9

Overview of items
