

# Hex Head Bushing

M12

MSS  
SP-114

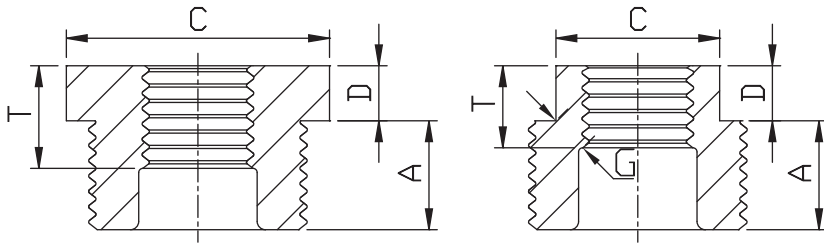

SIZE		A(Min.)		T(Min.)		G		D(Min.)		C	
		mm	in	mm	in	mm	in	mm	in	mm	in
1/4"	1/8"	11.18	0.44	6.6	0.26	-	-	3.05	0.12	5/8	5/8
3/8"	1/8"	12.7	0.5	6.6	0.26	-	-	4.06	0.16	11/16	11/16
	1/4"	12.7	0.5	10.16	0.4	-	-	4.06	0.16	11/16	11/16
1/2"	1/8"	14.22	0.56	6.6	0.26	-	-	4.83	0.19	7/8	7/8
	1/4"	14.22	0.56	10.16	0.4	-	-	4.83	0.19	7/8	7/8
	3/8"	14.22	0.56	10.41	0.41	-	-	4.83	0.19	7/8	7/8
3/4"	1/8"	15.75	0.62	6.6	0.26	-	-	5.59	0.22	1-1/16	1-1/16
	1/4"	15.75	0.62	10.16	0.4	-	-	5.59	0.22	1-1/16	1-1/16
	3/8"	15.75	0.62	10.41	0.41	-	-	5.59	0.22	1-1/16	1-1/16
	1/2"	15.75	0.62	13.46	0.53	-	-	5.59	0.22	1-1/16	1-1/16
1"	1/8"	19.05	0.75	6.6	0.26	-	-	6.35	0.25	1-3/8	1-3/8
	1/4"	19.05	0.75	10.16	0.4	-	-	6.35	0.25	1-3/8	1-3/8
	3/8"	19.05	0.75	10.41	0.41	-	-	6.35	0.25	1-3/8	1-3/8
	1/2"	19.05	0.75	13.46	0.53	-	-	6.35	0.25	1-3/8	1-3/8
	3/4"	19.05	0.75	13.97	0.55	-	-	6.35	0.25	1-3/8	1-3/8
1-1/4"	1/4"	20.57	0.81	10.16	0.4	4.57	0.18	7.11	0.28	1-3/4	1-3/4
	3/8"	20.57	0.81	10.41	0.41	4.57	0.18	7.11	0.28	1-3/4	1-3/4
	1/2"	20.57	0.81	13.46	0.53	4.57	0.18	7.11	0.28	1-3/4	1-3/4
	3/4"	20.57	0.81	13.97	0.55	-	-	7.11	0.28	1-3/4	1-3/4
	1"	20.57	0.81	17.27	0.68	-	-	7.11	0.28	1-3/4	1-3/4
1-1/2"	1/4"	20.57	0.81	10.16	0.4	5.08	0.2	7.87	0.31	2	2
	3/8"	20.57	0.81	10.41	0.41	5.08	0.2	7.87	0.31	2	2
	1/2"	20.57	0.81	13.46	0.53	5.08	0.2	7.87	0.31	2	2
	3/4"	20.57	0.81	13.97	0.55	5.08	0.2	7.87	0.31	2	2
	1"	20.57	0.81	17.27	0.68	-	-	7.87	0.31	2	2
	1-1/4"	20.57	0.81	18.03	0.71	-	-	7.87	0.31	2	2
2"	1/4"	22.35	0.88	10.16	0.4	5.59	0.22	8.64	0.34	2-1/2	2-1/2
	3/8"	22.35	0.88	10.41	0.41	5.59	0.22	8.64	0.34	2-1/2	2-1/2
	1/2"	22.35	0.88	13.46	0.53	5.59	0.22	8.64	0.34	2-1/2	2-1/2
	3/4"	22.35	0.88	13.97	0.55	5.59	0.22	8.64	0.34	2-1/2	2-1/2
	1"	22.35	0.88	17.27	0.68	5.59	0.22	8.64	0.34	2-1/2	2-1/2
	1-1/4"	22.35	0.88	18.03	0.71	-	-	8.64	0.34	2-1/2	2-1/2
	1-1/2"	22.35	0.88	18.29	0.72	-	-	8.64	0.34	2-1/2	2-1/2
2-1/2"	1/2"	26.92	1.06	13.46	0.53	6.1	0.24	9.65	0.38	3	3
	3/4"	26.92	1.06	13.97	0.55	6.1	0.24	9.65	0.38	3	3
	1"	26.92	1.06	17.27	0.68	6.1	0.24	9.65	0.38	3	3
	1-1/4"	26.92	1.06	18.03	0.71	6.1	0.24	9.65	0.38	3	3
	1-1/2"	26.92	1.06	18.29	0.72	-	-	9.65	0.38	3	3
	2"	26.92	1.06	19.3	0.76	-	-	9.65	0.38	3	3
	2-1/2"	26.92	1.06	19.3	0.76	-	-	9.65	0.38	3	3
3"	1/2"	28.45	1.12	13.46	0.53	6.6	0.26	10.41	0.41	3-1/2	3-1/2
	3/4"	28.45	1.12	13.97	0.55	6.6	0.26	10.41	0.41	3-1/2	3-1/2
	1"	28.45	1.12	17.27	0.68	6.6	0.26	10.41	0.41	3-1/2	3-1/2
	1-1/4"	28.45	1.12	17.78	0.7	6.6	0.26	10.41	0.41	3-1/2	3-1/2
	1-1/2"	28.45	1.12	18.29	0.72	6.6	0.26	10.41	0.41	3-1/2	3-1/2
	2"	28.45	1.12	19.3	0.76	-	-	10.41	0.41	3-1/2	3-1/2
	2-1/2"	28.45	1.12	28.96	1.14	-	-	10.41	0.41	3-1/2	3-1/2
	3"	28.45	1.12	30.48	1.2	-	-	12.7	0.5	4-5/8	4-5/8
4"	1"	31.75	1.25	17.27	0.68	7.87	0.31	15.24	0.6	4-5/8	4-5/8
	1-1/4"	31.75	1.25	17.78	0.7	7.87	0.31	15.24	0.6	4-5/8	4-5/8
	1-1/2"	31.75	1.25	18.29	0.72	7.87	0.31	15.24	0.6	4-5/8	4-5/8
	2"	31.75	1.25	19.3	0.76	7.87	0.31	15.24	0.6	4-5/8	4-5/8
	2-1/2"	31.75	1.25	28.96	1.14	7.87	0.31	15.24	0.6	4-5/8	4-5/8
	3"	31.75	1.25	30.48	1.2	-	-	12.7	0.5	4-5/8	4-5/8



TRD 100

Type Approval P-13548

CE CRN 0035 REGISTERED

A3

AP 6D-1017

Ex ATEX II 2GD

TA-Luft ISO 15848 REACH

VDI 2440 LOW EMISSION (EC 1907/2006)

R6HS