

Item description/product images



Description

Version:
Bright.

Drawings

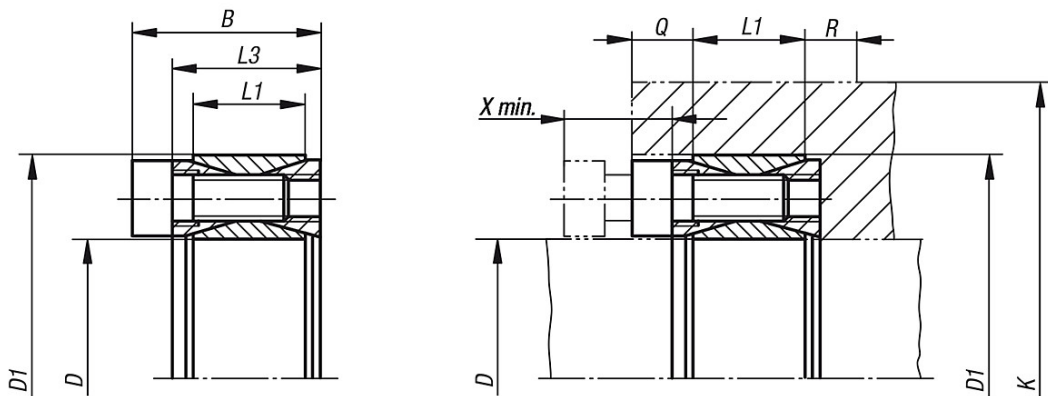

Overview of items

Order No.	D	D1	B	L1	L3	Torque M Nm transmissible at tightening torque MS	Axial force F kN transmissible at tightening torque MS	Surface pressure on shaft P N/mm ²	Surface pressure on hub P N/mm ²
70-1-1	20	47	26	17	20	110	11	133	57
70-1-2	25	50	26	17	20	155	12	120	60
70-1-3	30	55	26	17	20	185	12	100	55
70-1-4	35	60	26	17	20	290	16	114	67
70-1-5	40	65	26	17	20	410	20	125	77
70-1-6	45	75	32	20	24	635	28	129	78
70-1-7	50	80	32	20	24	700	28	116	73
70-1-8	55	85	32	20	24	905	33	123	80
70-1-9	60	90	32	20	24	990	33	113	76
70-1-10	65	95	32	20	24	1.225	37	119	82
70-1-11	70	110	38	24	28	1.875	53	131	84
70-1-12	75	115	38	24	28	2.010	53	123	80
70-1-13	80	120	38	24	28	2.145	53	115	77

Order No.	Clamping screws DIN 912	Clamping screws tightening torque MS in Nm	Elasticity limit Re (N/mm ²) of the hub material 190 K min. mm	Elasticity limit Re (N/mm ²) of the hub material 320 K min. mm	Elasticity limit Re (N/mm ²) of the hub material 550 K min. mm	Elasticity limit Re (N/mm ²) of the hub material 600 K min. mm	X min. mm
70-1-1	M6	8	60	57	54	54	30
70-1-2	M6	8	65	61	58	58	30
70-1-3	M6	8	70	66	63	63	30
70-1-4	M6	8	80	74	69	69	30
70-1-5	M6	8	91	82	76	75	30
70-1-6	M8	18	105	94	87	86	40
70-1-7	M8	18	110	99	92	91	40
70-1-8	M8	18	121	107	99	98	40
70-1-9	M8	18	125	117	104	103	40
70-1-10	M8	18	136	120	110	109	40
70-1-11	M10	35	159	133	127	126	45
70-1-12	M10	35	163	144	132	131	45

Overview of items

Order No.	Clamping screws DIN 912	Clamping screws tightening torque MS in Nm	Elasticity limit Re (N/mm ²) of the hub material 190 K min. mm	Elasticity limit Re (N/mm ²) of the hub material 320 K min. mm	Elasticity limit Re (N/mm ²) of the hub material 550 K min. mm	Elasticity limit Re (N/mm ²) of the hub material 600 K min. mm	X min. mm
70-1-13	M10	35	168	149	137	136	45