

Return rollers

Example of application

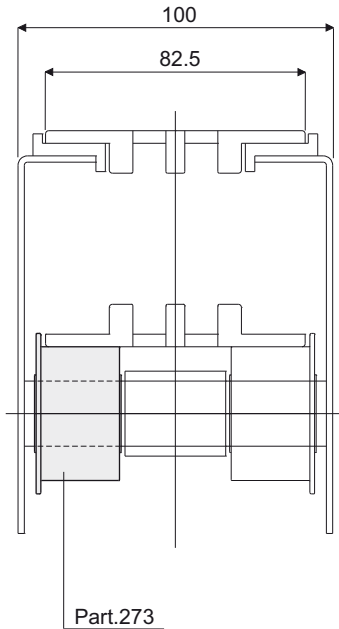

Roller for chain return (with flange)

Part. **273**

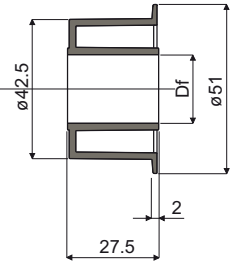
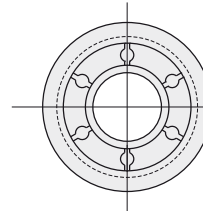

Df Bore for pin of (mm)	Code
12	273 / 82048
16	273 / 82049
18	273 / 82050
20	273 / 82051

MATERIALS: Roller made of polyamide black colour.

FEATURES: To be assembled in the chain return.

BOX QUANTITY: 96 pieces.

ON REQUEST:

- Rollers: Special bores, other colours.
- Box Quantity: According to your request.

Example of application

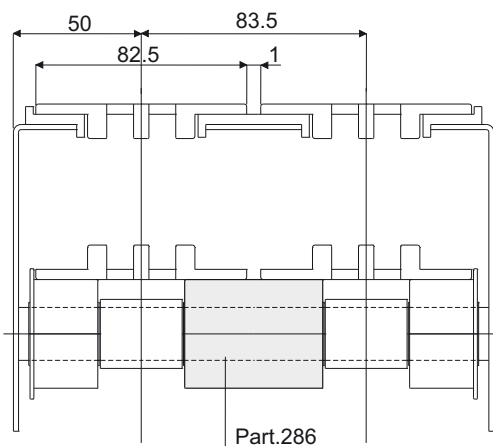

Double roller for chain return (without central flange)

Part. **286**

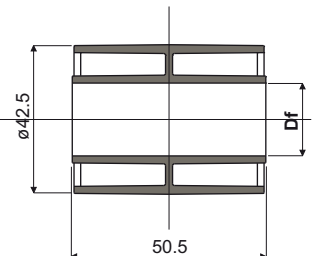
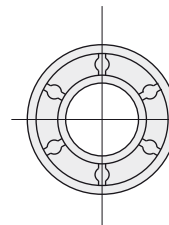

Df Bore for pin of (mm)	Code
12	286 / 82532
16	286 / 82533
18	286 / 82534
20	286 / 82535

MATERIALS: Roller made of polyamide black colour.

FEATURES: To be assembled in the chain return.

BOX QUANTITY: 96 pieces.

ON REQUEST:

- Rollers: Special bores, other colours.
- Box Quantity: According to your request.