

Product guides and accessories

Extruded product guide rails in coils of 50 Mt.

Part. **370**

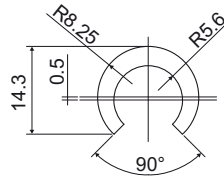

Code

370 / 83726

Materials: Extruded HMWPE white colour.

Standard Packing: This item is sold in Mt. - min. 50 Mt.

Features: To be used with 10 mm diameter rods.

On request:

- Guide rails: Different colours and lengths.

Extruded product guide rails in coils of 50 Mt.

Part. **371**

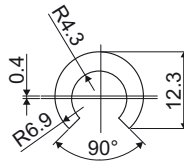

Code

371 / 83727

Materials: Extruded HMWPE white colour.

Standard Packing: This item is sold in Mt. - min. 50 Mt.

Features: To be used with 8 mm diameter rods.

On request:

- Guide rails: Different colours and lengths.

Extruded product guide rails in 6 Mt. lengths

Part. **372**

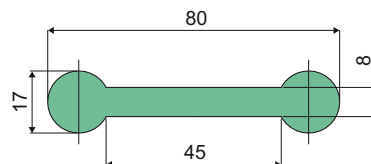

Code

372 / 83728

Materials: Extruded HMWPE green colour.

Standard Packing: This item is sold in Mt. - min. 12 Mt. (2 lengths).

On request:

- Guide rails: Different colours and lengths.