

Clamp union ISO2037

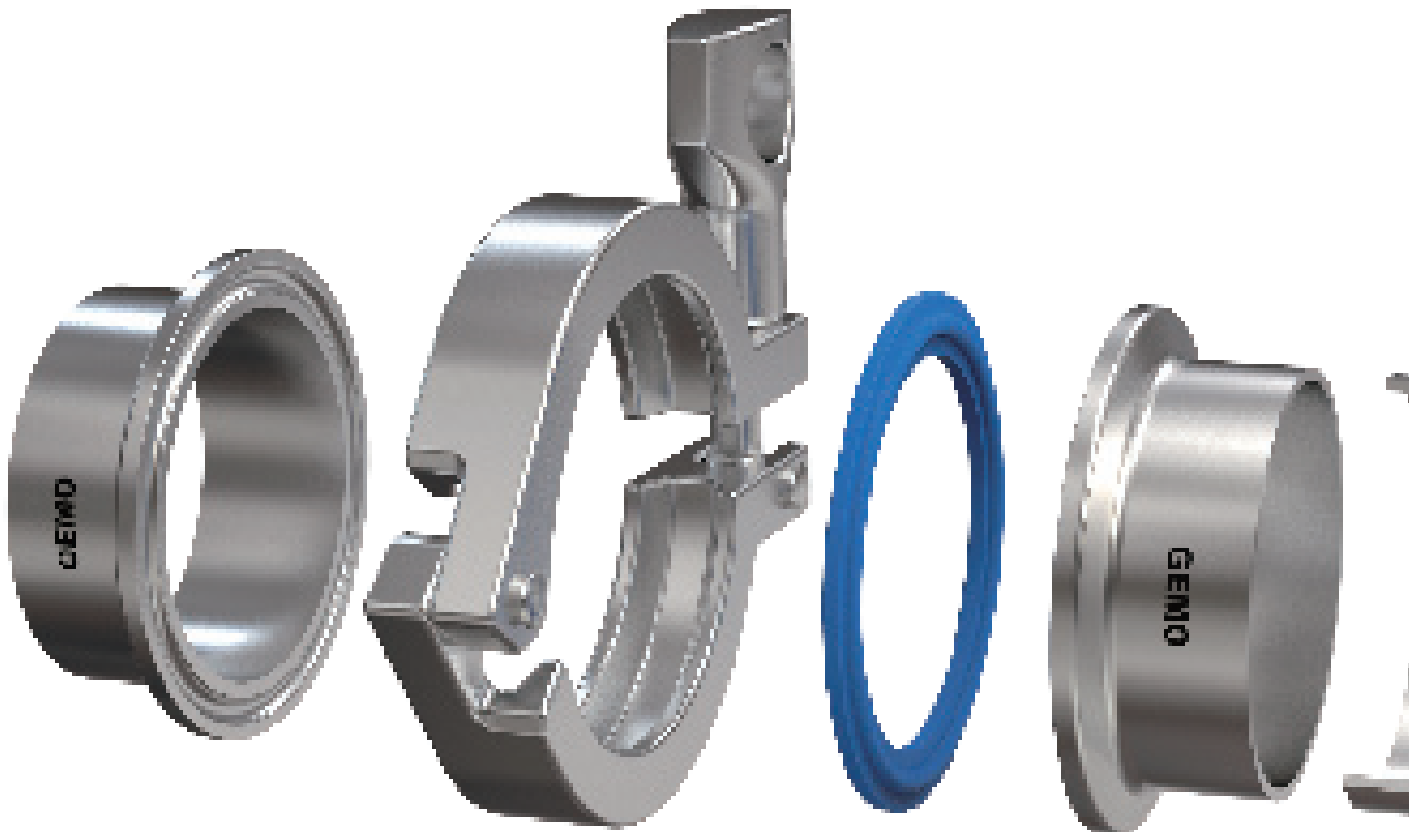

Clamp ferrule acc. To ISO2037.

13MHHM Double pin heavy duty clamp in page 16 can apply to ISO2037

EACH FITTINGS PACKAGING HAS A BARCODE

CLAMP UNION ISO2037

Part for Inch tubes

Wall Thickness: Fittings OD25-OD51mm sizes can also be manufactured with 1.6mm wall thickness.

TUBES AND FITTINGS **GEMO**

Finish: OD: Semi bright. ID: Semi bright

1.3

S14MMP

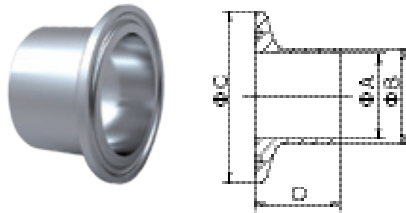

Basic Ordering Number: 8018

NO.	Size	A	B	C	D
8018 02500	25	22.5	25	50.5	21.5
8018 03200	32	29.5	32	50.5	21.5
8018 03800	38	35.5	38	50.5	21.5
8018 05100	51	48.5	51	64.0	21.5
8018 06350	63.5	60.3	63.5	77.5	21.5
8018 07600	76	72.9	76.1	91.0	21.5
8018 10160	101.6	97.6	101.6	119.0	21.5

**1.4301 and 1.4404 are available.

40MP

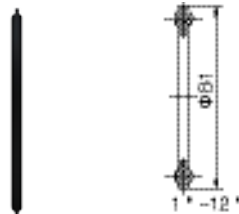

Basic Ordering Number: 8019

NO.	Size	B1
8019 02538	25-38	50.5
8019 05100	51	64
8019 06350	63.5	77.5
8019 07600	76	91
8019 10160	101.6	119

**Silicone, EPDM, FPM and PTFE are available.

16AMP



Basic Ordering Number: 8020

NO.	Size	A	B
8020 02538	25-38	50.5	6.4
8020 05100	51	64.0	6.4
8020 06350	63.5	77.5	6.4
8020 07600	76	91.0	6.4
8020 10160	101.6	119.0	7.9

**1.4301 and 1.4404 are available.

A13MHM

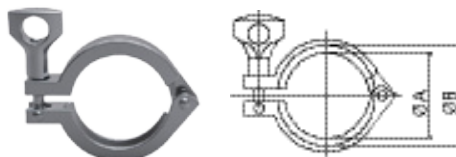

Basic Ordering Number: 8021

NO.	Size	A	B
8021 02538	25-38	44.4	53.6
8021 05100	51	57.8	67
8021 06350	63.5	71.4	80.6
8021 07600	76	84	94.2
8021 10160	101.6	110	122.2

**Only 1.4301 is available.

NOTE!

**All measurements are in millimeters (mm)
Conversion to inches, 25.4mm=1inch

P&E Flow Technology Profile

P&E Flow Technology is provider of professional products for the fluid industry and related solutions.

We are committed to brew processing, beverage processing, Dairy and Foodstuff processing, pharmaceutical industry, water treatment works, Bio-engineering and fluid technology industry

P&E Flow Technology Brands

CKAN

ZIMANI

GEMO

Meatier

Shst

How to contact P&E Flow Technology
www.pestainless.com

GEMO Products Services
Please visit and contact us:
www.gemoindustries.com

Technical Support
Tech@gemoindustries.com

Service
Info@gemoindustries.com

Dealer Management
DealerManagement@gemoindustries.com

P&E Flow Technology

Address: Shacheng Street, WenZhou, P.R China.
Post Code: 325000

Service, Sales
Tel: +86-577-85826961
Email: Info@pestainless.com

Dealer Management
Email: DealerManagement@pestainless.com

Copyright © 2011 P&E

GEMO is a trademark registered and owned by P&E Flow Technology. P&E reserves the right to change specifications without prior notify action.